

Soil Volume for Tree Planting

Soil Area	Soil Area (m ²)	Soil Depth (m)*	Soil Volume (m ³)	Tree Quantity	Soil Volume per tree (m ³)	Irrigation provided (Yes/No)
1	8	0.45	3.6	0	n/a	Yes
2	7	0.45	3.15	0	n/a	Yes
3	4	0.45	1.8	0	n/a	Yes
4	3	0.45	1.35	0	n/a	Yes
Totals	22	1.8	9.9	0		

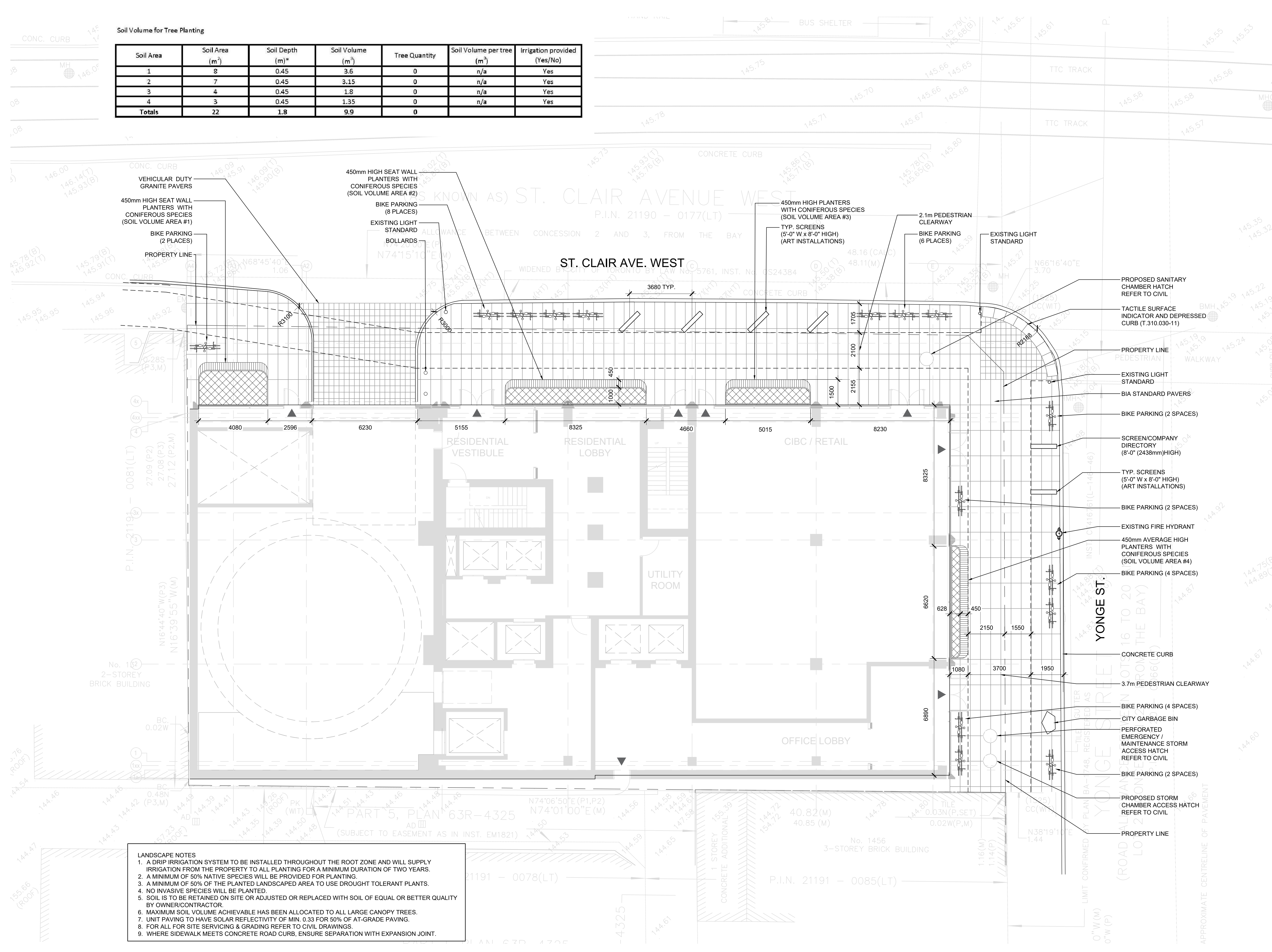

- LANDSCAPE NOTES**
- A DRIP IRRIGATION SYSTEM TO BE INSTALLED THROUGHOUT THE ROOT ZONE AND WILL SUPPLY IRRIGATION FROM THE PROPERTY TO ALL PLANTING FOR A MINIMUM DURATION OF TWO YEARS.
 - A MINIMUM OF 50% NATIVE SPECIES WILL BE PROVIDED FOR PLANTING.
 - A MINIMUM OF 50% OF THE PLANTED LANDSCAPED AREA TO USE DROUGHT TOLERANT PLANTS.
 - NO INVASIVE SPECIES WILL BE PLANTED.
 - SOIL IS TO BE RETAINED ON SITE OR ADJUSTED OR REPLACED WITH SOIL OF EQUAL OR BETTER QUALITY BY OWNER/CONTRACTOR.
 - MAXIMUM SOIL VOLUME ACHIEVABLE HAS BEEN ALLOCATED TO ALL LARGE CANOPY TREES.
 - UNIT PAVING TO HAVE SOLAR REFLECTIVITY OF MIN. 0.33 FOR 50% OF AT-GRADE PAVING.
 - FOR ALL FOR SITE SERVICING & GRADING REFER TO CIVIL DRAWINGS.
 - WHERE SIDEWALK MEETS CONCRETE ROAD CURB, ENSURE SEPARATION WITH EXPANSION JOINT.

NOTES

The following note shall apply to all drawings and associated documents:
 Copyright of this drawing and design is reserved by the Designer. The drawing and all associated documents are an instrument of service by the Designer. The drawing and all associated documents are not to be reproduced in whole or in part without prior written permission of the Designer.
 These Contract Documents are the property of the Landscape Architect. The Landscape Architect bears no responsibility for the interpretation of these documents by the Contractor. Upon written application the Landscape Architect will provide written clarification or supplementary information regarding the intent of the Contract Documents. The Landscape Architect will review Shop Drawings submitted by the Contractor for design conformance only.
 Drawings are not to be scaled for construction. Contractor to verify all existing conditions and dimensions required to perform the work and report any discrepancies with the Contract Documents to the Landscape Architect before commencing work.
 Portions of exposed or finished mechanical or electrical devices, fittings, and fixtures are indicated on Landscape Architectural drawings. The locations shown on the Landscape Architectural drawings govern over the Mechanical and Electrical drawings. Those items not clearly located will be located as directed by the Landscape Architect. These drawings are not to be used for construction unless noted below as "Issued for Construction".
 All work to be carried out in conformance with the Code and Bylaws of the authorities having jurisdiction.
 The Designer of these plans and specifications gives no warranty or representation to any party about the constructability of the represented by them. All contractors or subcontractors must satisfy themselves when bidding and at all times that they can properly construct the work represented by these plans.

LEGEND

PLANTING BED

ISSUE

NO.	DATE	DESCRIPTION
10		
9		
8		
7		
6		
5		
4		
3		
2		
1	2021-12-10	ISSUED FOR REZONING

Janet Rosenberg & Studio
 Landscape Architecture and Urban Design
 416 656 6665 | 416 656 5756 | www.jrstudio.co
 148 Kenwood Avenue, Toronto Ontario M6C 2B3 Canada

MIDTOWN-YONGE PROPERTIES INC.

1 ST. CLAIR AVE. WEST
 ST. CLAIR AVE. WEST AND YONGE ST.

LANDSCAPE LAYOUT PLAN

SCALE: 1:100
 DRAWN: AS
 CHECKED: TD
 PROJECT NUMBER: 21-030
 DRAWING DATE: 2021-11-09

L100

